

FRONT VIEW

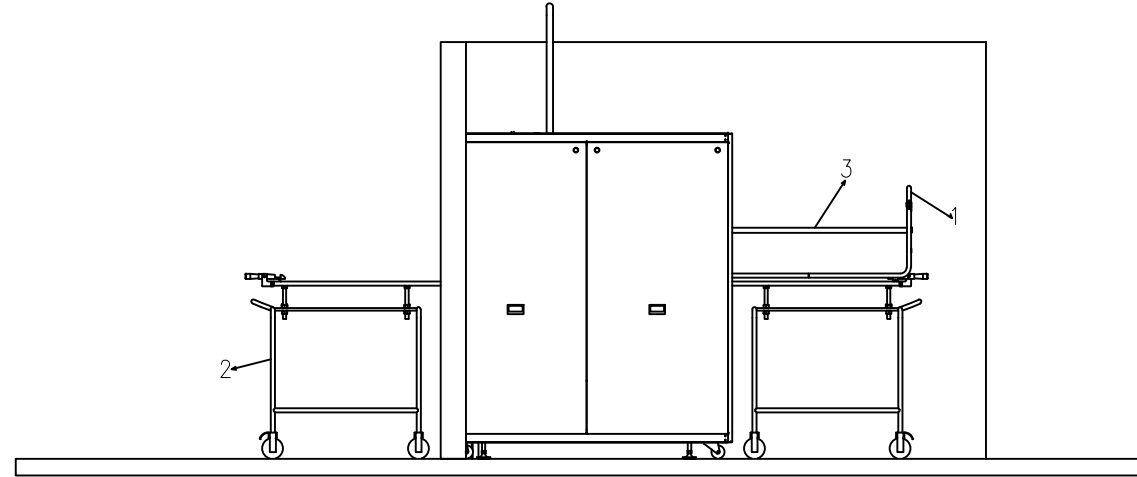

SIDE VIEW

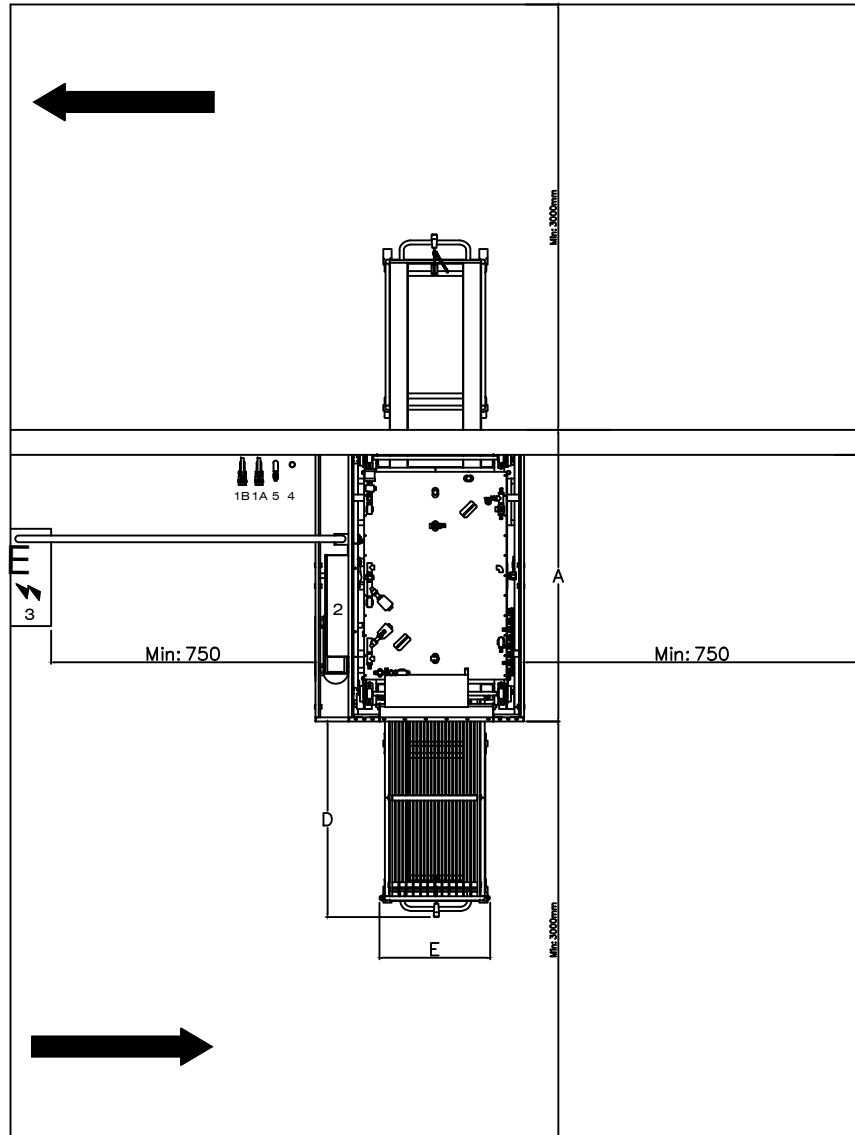

TOP VIEW

- 1A. FEED WATER CONNECTION
 Connection: 3/4" male DN 20mm
 Pressure: min. 2 Bar max. 5 Bar
 Heat: min. 5°C max. 20°C
 Height: min. 100mm max. 150mm
 Water quality according EN 285 Annex B
 Machine Water inlet height: 700mm
- 1B. DEMINERALIZED WATER CONNECTION
 Connection: 3/4" male DN 20mm
 Pressure: min. 2 Bar max. 5 Bar
 Heat: min. 5°C max. 20°C
 Height: min. 100mm max. 150mm
 Water quality according EN 285 Annex B
 Machine Water inlet height: 700mm
2. ELECTRICAL CONNECTION AUTOCLAVE
 Volt: 380V, 3P+N+G
 Hz: 50Hz
 Power: (TABLE - F)
 Machine mains supply connection height: 1700mm
3. ELECTRICAL CONNECTION ROOM
 Volt: 380V, 3P+N+G CIRCUIT BREAKER (SEE TABLE - F)
 Hz: 50Hz
4. DRAIN
 250 lt and 690 lt Connection: Min: 1" Male galvanized pipe
 740 lt and 900 lt Connection : Min: 1 1/2" Male galvanized pipe
 Drain temperature : 96 °C
 Height: min. 50mm max. 100mm
 Machine drain height : 150mm
5. PRESSURED AIR SUPPLY(OPTIONAL):
 Connection: 1/2" male
 Flow: 5 lt/min.
 Pressure: 5 - 5.9 Bar
 Height: min. 1000mm max. 1500mm

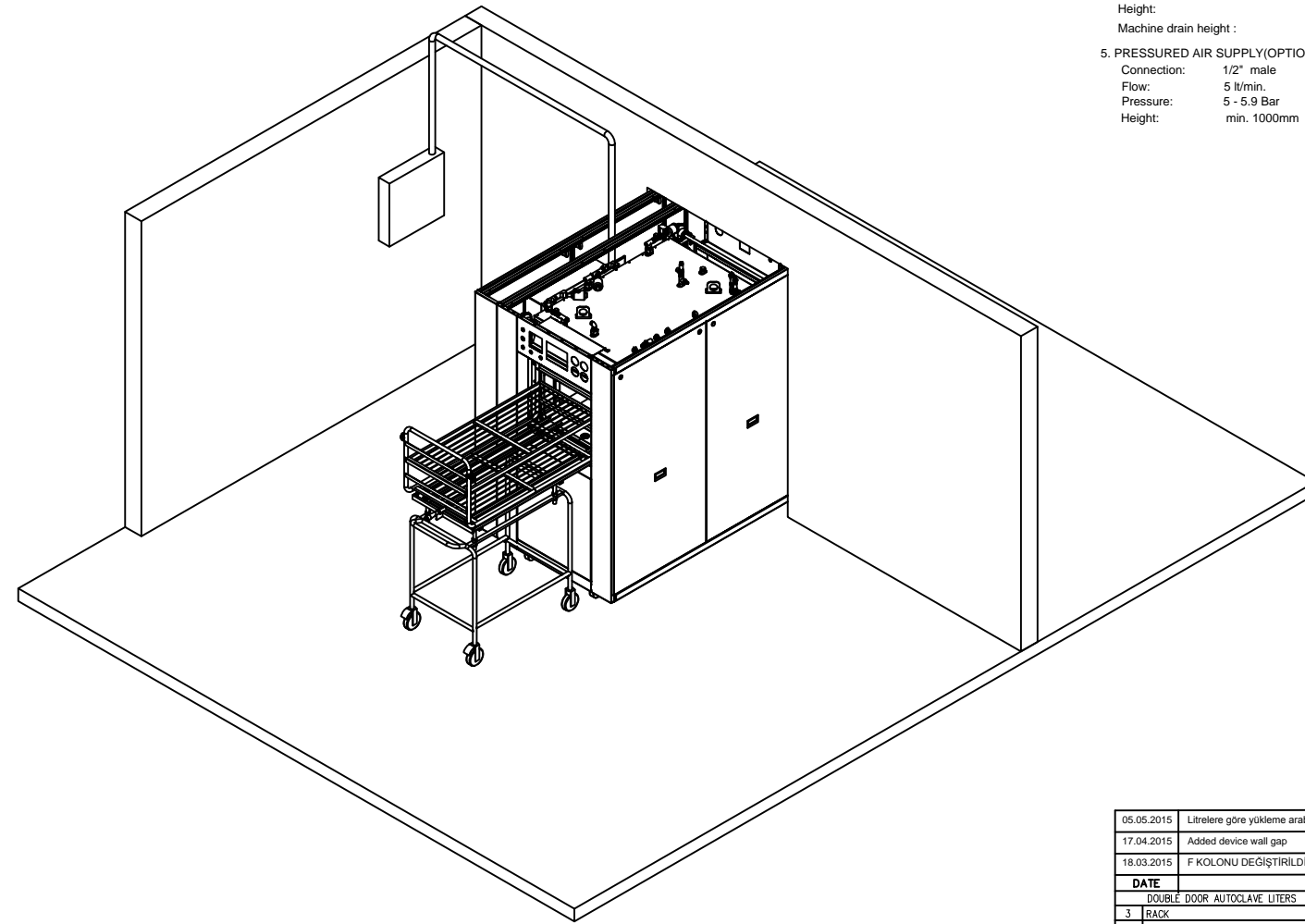

CHAMBER VOLUME	DIMENSION (mm)					
	A	B	C	D	E	F
160 LT	1235	770	1950	-	-	40 A
250 LT	1500	1100	1800	980	450	63 A
330 LT	1250	1250	1950	980	600	63 A
420 LT	1450	1250	1950	980	600	80 A
555 LT	1750	1250	1950	1230	600	100 A
670 LT	2000	1250	1950	1480	600	125 A
690 LT	2050	1250	1950	980	600	125 A
740 LT	2160	1250	1950	980	600	125 A
825 LT	2345	1250	1950	980	600	125 A
900 LT	2100	1500	1950	980	830	125 A

DATE	NOTE	REV.																																				
05.05.2015	Litrelerce göre yükleme arabası ihtiyacı belirlendi.	1																																				
17.04.2015	Added device wall gap	2																																				
18.03.2015	F KOLONU DEĞİŞTİRİLDİ	3																																				
<table border="1"> <thead> <tr> <th>DOUBLE DOOR AUTOCLAVE LITERS</th> <th>250 LT</th> <th>330 LT</th> <th>420 LT</th> <th>555 LT</th> <th>670 LT</th> <th>740 LT</th> <th>825 LT</th> <th>900 LT</th> </tr> </thead> <tbody> <tr> <td>3 PACK</td> <td>1</td> <td>1</td> <td>1</td> <td>1</td> <td>1</td> <td>2</td> <td>2</td> <td>2</td> </tr> <tr> <td>2 LOADING TROLLEY</td> <td>2</td> <td>2</td> <td>2</td> <td>2</td> <td>2</td> <td>4</td> <td>4</td> <td>4</td> </tr> <tr> <td>1 LOADING BASKET</td> <td>1</td> <td>1</td> <td>1</td> <td>1</td> <td>1</td> <td>2</td> <td>2</td> <td>2</td> </tr> </tbody> </table>			DOUBLE DOOR AUTOCLAVE LITERS	250 LT	330 LT	420 LT	555 LT	670 LT	740 LT	825 LT	900 LT	3 PACK	1	1	1	1	1	2	2	2	2 LOADING TROLLEY	2	2	2	2	2	4	4	4	1 LOADING BASKET	1	1	1	1	1	2	2	2
DOUBLE DOOR AUTOCLAVE LITERS	250 LT	330 LT	420 LT	555 LT	670 LT	740 LT	825 LT	900 LT																														
3 PACK	1	1	1	1	1	2	2	2																														
2 LOADING TROLLEY	2	2	2	2	2	4	4	4																														
1 LOADING BASKET	1	1	1	1	1	2	2	2																														
POZ	MATERIAL DESCRIPTION	QUANTITY																																				

TRANS
GETİNCE
GETİNCE ÜRÜNLERİ

TRANS MEDİKAL ALETLER SANAYİ VE TİCARET A.Ş.
CEVAT DÜNDAR CADDESİ 65.SOKAK NO:1 OSTİM / ANKARA TÜRKİYE

Project Name
VERTICAL DOUBLE DOOR LEFT SERVICE AUTOCLAVE INSTALLATION DRAWINGS

Manufacture
TRANS MEDİKAL ALETLER SANAYİ VE TİCARET A.Ş.
CEVAT DÜNDAR CAD. 65.SOKAK NO:1 OSTİM / ANKARA TÜRKİYE

Design and Application
TRANS MEDİKAL ALETLER PROJE DEPARTMANI

Name	Date	Sing.	Scale	Paper	Archive No :
Design	SELÇUK ONDAG 07.11.2014			AD	
Application	ERKAN USTABAŞ 07.11.2014				
Control	BÜLENT ASLAN 07.11.2014				
Approval	BÜLENT ASLAN 07.11.2014				

NOVEMBER - 2014

Revision No : 3

(#) Water quality according EN 285 Annex B